

HIL-GLM-15-22 TUBE BENDER



The Hilmor HIL-GLM-15-22mm is a compact tube bender featuring precision high aluminium die-cast formers and guides to produce sets, offsets, multiple bends in tubes of a maximum diameter of 22mm (7/8").

Capacities GLM
15 & 22mm copper to BS2871.
15 & 22mm mild steel to BS4182.
15 & 22mm stainless steel to BS4127
7/8" copper

FEATURES

- Compact bender suitable for **copper**, **stainless steel** and **mild steel**
- Suitable for installation of small heating and refrigeration systems
- A comfortable ergonomic non-slip grip
- Constructed out of lightweight steel for a lighter and easier to carry tool
- 15 mm and 22 mm formers and guides and in the box
- Suitable for 7/8" copper

INFORMATION

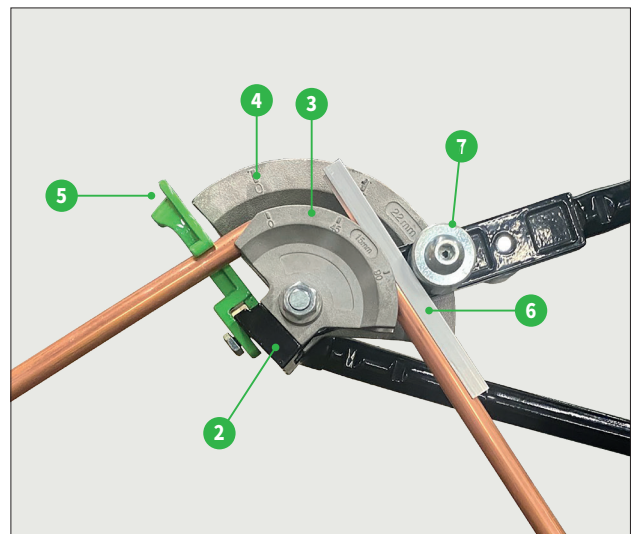

- | | |
|--------------------|-----------------|
| 1. Swivel arm | 5. Tube locator |
| 2. Housing bracket | 6. Guide |
| 3. 15mm former | 7. Roller |
| 4. 22mm former | |

Precise Angles
Calibrated markings for making accurate bends up to 180°.

Comfortable Grip
Non-slip grip.

Lighten Your Load
Constructed out of lightweight die-cast aluminum.

**GET IN.
GET OUT.
GET ON TO
THE NEXT
JOB!**

Note: For best results ensure that the formers and guides are clean and free from grit or other particles. Keep the swivel arm/pivot bolt/former housing bracket, and the roller studs lubricated.

This machine is designed to bend the materials specified, and should not be used to bend other materials without prior approval of the manufacturer.

Model	Description
HIL-GLM-15-22	HIL-GLM-15-22

TOOLS
HIL-GLM-15-22
 HAND TUBE BENDER

The DiversiTech International sales team are available to answer your questions or queries on this product. Our experts are waiting for your call +44 (0)115 900 5858 or if you prefer send an email to sales@diversitech.com or visit www.diversitech.global



Glaisdale Drive East
 Nottingham NG8 4LY
 United Kingdom