



SOCKET BOLTS LOOSE M8-M10 (3-PIECE)



Screw anchor TSM 6x35 and 6x55 by M8/M10 (countersunk head with metric internal thread)

For fastening pipelines, ceiling brackets, ventilation ducts and timber substructures.

ETA-15/0514

ETA-16/0123



FEATURES

- Undercutting action
- Fast and Secure Installation
- Expansion Free
- High Performance
- Reaction to Fire Class A1
- Fire Resistant Classification R120
- Fast and reliable to install
- High load-bearing capacity in cracked and non-cracked concrete
- Variable internal thread for metric screws and threaded rods M8 and M10
- Load transfer through free spin zone
- Complete removal if required
- Immediately resilient

APPLICATION

- For use as single fastener according to ETAG 001; Part 3 in non-cracked concrete (see ETA-15/0514)
- For use as a multiple fastener for non-supporting systems in cracked and non-cracked concrete and reinforced concrete hollow-slab ceilings (see ETA-16/0123)
- Suitable for natural stone with compact structure
- For fastening pipelines, ceiling brackets, ventilation ducts and timber substructures

BASE MATERIAL

- Concrete C20/25 to C50/60
- Hollow Concrete Planks
- Solid Brickwork
- Concrete Block
- Natural Stone

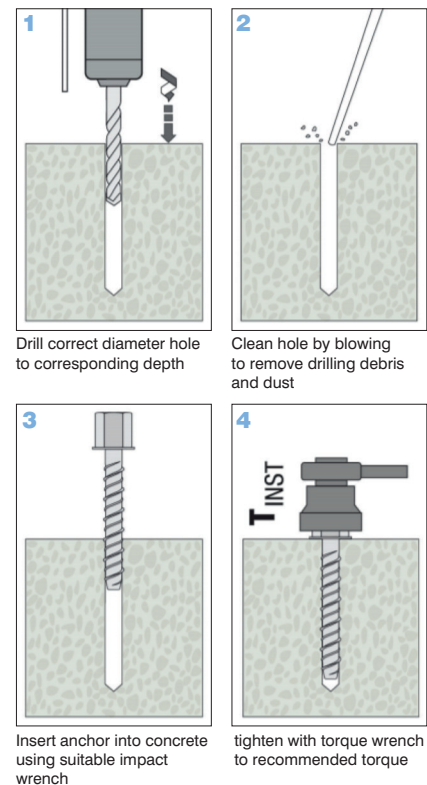

Part code	Description	Quantity
X-SBL-810-35-B50	Socket bolt loose M8-M10 (3 piece) 35mm	Box of 50
X-SBL-810-55-B50	Socket bolt loose M8-M10 (3 piece) 55mm	Box of 50

FIXINGS
SOCKET BOLTS
 socket bolts loose m8-m10 (3-piece)

The DiversiTech International sales team are available to answer your questions or queries on this product. Our experts are waiting for your call +44 (0)115 900 5858 or if you prefer send an email to sales@diversitech.com or visit www.diversitech.global

DIVERSITECH
 INTERNATIONAL

Glaisdale Drive East
 Nottingham NG8 4LY
 United Kingdom